

*Protect
Your Family!*

Total Visibility • More Security • Feel Safer

Features:

- Easy to Install & Operate
- Real-time Non-Distorted View
- Records Visitors' Images Automatically
- Stores up to 140 Pictures
- Includes Door Bell & Intercom

Applications:

- Ideal for apartments, condos, houses, dorms and other indoor areas.
- Suitable for users of all ages especially senior citizens, kids, college students, housewives, professionals and people living alone

DOOR GUARD

**4-in-1
Digital Security
Viewer**



***Operating Instructions
Includes important information
Read all instructions before using device***

Introduction

Congratulations and thank you for purchasing the DoorGuard digital security viewer which gives you better visibility and help safeguards your home.

This Operation manual contains important information on the use and operation of the DoorGuard. Please read carefully all information before using the device.

Index

DoorGuard Features	02
Specification	02
Indoor Viewing Unit	03
Outdoor Recording Unit	03
Checking the Package Contents	04
Before Installation	04
Installation	05
Settings	09
Operation	10
Warning	11
Proper Battery Handling	12
Trouble Shooting	13
Limited Warranty	14
Product Registration	14
Contact Us	14

DoorGuard Features

- 4 in 1 security door viewer – built-in digital camera, color display, intercom, and chimes.
- User-friendly design – so simple to use that even senior citizens and kids can operate.
- Hassle free installation – replace the optical door viewer in minutes.
- High sensitive camera – the visitor's picture can be taken even in poor light conditions.
- 2.4 in (6 cm) TFT color screen – provides clear and non-distorted images.
- Unbreakable and weather-resistant outdoor unit.
- Auto/Manual picture-taking function.
- Built-in memory – stores up to 140 pictures.
- Date & time mark on all pictures taken.
- Energy saving – automatically switches to stand-by mode when left idle for 30 seconds.
- Extra long battery life – operates on 4 x AA alkaline batteries with runtime more than 1 year.
- Choice of bell tones – pick from 5 different sounds.
- Volume control – slide switch to adjust door bell sound level.
- Stylish colors – available in black or silver.

Specification

Indoor Unit Size (W x H x D)	115 x 112 x 23mm (4.5 x 4.4 x 0.9 in)
Outdoor Unit Size (W x H x D)	38 x 76 x 20mm (1.5 x 3 x 0.8 in)
Screen Type	TFT color type, 115,200 pixel
Screen Size (W x H)	49 x 36.7mm (2.4 inches diagonal)
Camera	Color CMOS sensor, 0.3M pixel
Built-in Memory	min 32MB (stores up to 140 pictures)
Built-in Chime	5 selections
Power	4 x 1.5V AA size (AM3, LR6, SUM3, R6) alkaline batteries
Runtime	Approximately 1 year
Operation Temperature	0 - 50°C (32 - 122° F)
Operation Humidity	10 - 90%
Door Thickness	25 to 65mm (1 to 2.5 inches)
Spy Hole Diameter	14mm (9/16 in) or 23 mm (7/8 in)

Indoor Viewing Unit

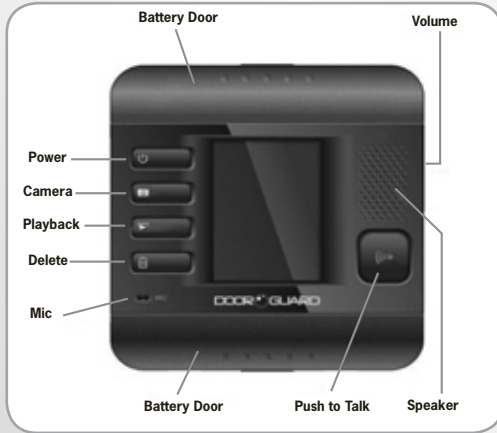

Outdoor Recording Unit

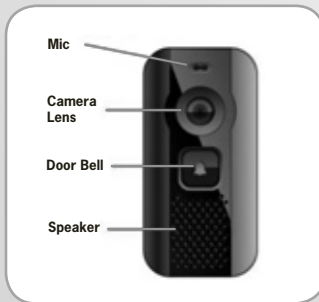

Checking the Package Contents:

- 1) DoorGuard Outdoor Unit (with connecting cable) x 1
- 2) DoorGuard Indoor Unit x 1
- 3) U shape mounting plate x 1
- 4) Screws x 2 sets
- 5) 1.5V AA size battery x 4
- 6) Operating Instructions Manual

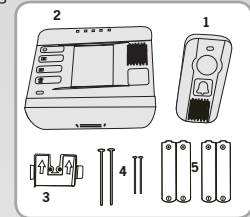

Before Installation

• Checking Door Thickness

- Please check the thickness of your door and select the correct length of the screws.

Door Thickness	Screw Length
25-45mm (1 - 1 ¾ in)	30mm (1.18 in) (Wrapped in White Label)
45-65mm (1 ¾ - 2 ½ in)	45mm (1.77 in) (Wrapped in Black Label)

• Checking Spy Hole Diameter

- Please check the diameter of the spy hole and decide whether you need the soft ring

Spy Hole Diameter	Action
14mm (9/16 inch)	Remove the black color soft ring before installation
23mm (7/8 inch)	Keep the black color soft ring on the outdoor unit.

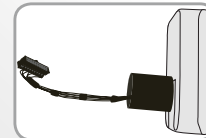

If door hole is 23mm, keep the black color soft ring

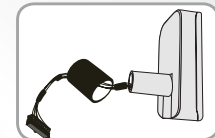

If door hole is 14mm, remove the black color soft ring

Installation

• Tools Required:

- Philips head (+) screw driver x 1
- Round coin x 1

• Installing Batteries

- 1) Open both battery doors by depressing the tab at the center of the battery door then pull out from the unit. Repeat the procedure for the bottom battery door.



- 2) Insert two AA size alkaline batteries on each battery compartment. (4 AA size alkaline batteries are supplied with the unit).

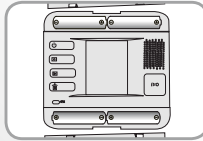

- 3) Be careful to load the batteries with their positive (+) and negative (-) ends in the right direction.

- 4) Close the battery doors by first inserting the two plastic tabs into the anchoring holes of the battery compartment. Then, press the center tab and push in until you hear a "click" sound.

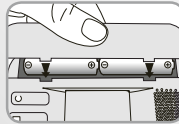

Remarks:

- o Pictures are stored in the built-in flash memory. Information will be retained in the memory even without batteries.

• Installing Outdoor Recording Unit

- 1) Remove the optical door viewer from the spy hole by turning the inner part with a coin.
- 2) Make sure the door surface around the spy hole is clean and free from dirt and grease.

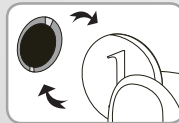

- 3) Peel off the cover of the double side tape on the back of the outdoor unit. Slightly bend the plug so it parallels with the cable.

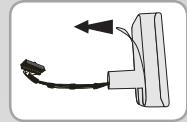

- 4) Insert the cable and tube into the spy hole from outside and pass the cable through the spy hole. Make sure the plug comes out from the other side of the door.

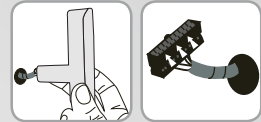

- 5) Attach the outdoor unit to the door by pressing firmly.

- 6) On the other side of the door, align the mounting plate with the spy hole with the label facing you and the U-shape groove in upright position. Rest the cable over the groove.

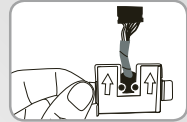

- 7) Insert the screws through the holes on the mounting plate. Align the screws with the nuts on the tube. Slightly turn the screw a few times by hand to fix it on the nut. Tighten the screws with a screw driver.

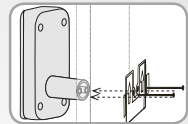

Note:

1. The DoorGuard is designed to fit with doors with thickness range from 25mm to 65mm (1 to 2.5 inches). We supply two sets of screws to fit with different thicknesses of doors. Please refer to P.4 "Before Installation" section on choosing the correct length of screws.
2. Do not over tighten the screws or the mounting plate may be deformed.

- **Installing Indoor Viewing Unit**

- 1) Plug the outdoor unit cable to the socket at the back of the indoor unit. The cable plug is marked with arrows and is polarized. Please make sure the arrows matched with those on the back of the indoor unit and the small black tab pointing downward. Press firmly to ensure good connection.



- 2) Place the indoor unit on top of the spy hole. Slightly press the indoor unit against the door and slide it downward to fit onto the mounting plate.

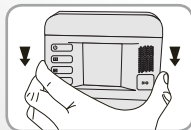

- **Disabling your existing doorbell.**

If you have already an existing doorbell installed at your home, please disable your existing doorbell to allow optimum use of the DoorGuard.

- **Replacing Batteries**

- 1) When the symbol  appears on the screen, the power is weak. Replace all four batteries immediately.
- 2) Remove the indoor unit from the mounting plate by sliding it upward and detach the connecting cable.

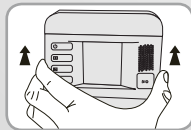

- 3) Lay the unit flat on the table. Open both battery doors by depressing the tab at the center of the battery door then pull out from the unit. Repeat the procedure for the bottom battery door.



- 4) Replace all four batteries with fresh AA size alkaline batteries.
- 5) Be careful to load the batteries with their positive (+) and negative (-) ends in the right direction.

- 6) Close the battery doors by first inserting the two plastic tabs into the anchoring holes of the battery compartment. Then, press the center tab and push in until you hear a “click” sound.

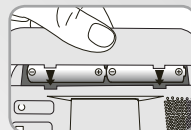

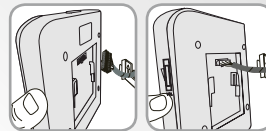

- 7) Plug the outdoor unit cable to the socket at the back of the indoor unit.





- 8) Place the indoor unit on top of the spy hole. Slightly press the indoor unit against the door and slide it downward to onto the mounting plate.







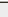
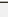
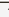

Settings

- 1) User needs to set the time and date after installing batteries for the first time and after replacing batteries.
- 2) Turn on the unit by pressing the **POWER**  button Hold the **POWER**  button for 2 seconds to bring up the set up menu.
- 3) The set up menu appears like this

MM/DD/YY	DD/MM/YY
----------	----------
- 4) Press the **CAMERA**  button to select either the American date format **MM/DD/YY** or the European date format **DD/MM/YY**. The selected format is highlighted in red color. Hold the **POWER**  button for 2 seconds to save the setting and bring up the next set up menu.
- 5) The next set up menu appears like this









 01	01/01/01	00:00
--	----------	-------

 Chimes  Date  Time
- 6) Press the **CAMERA**  button to select the items on the menu. Press the **PLAYBACK**  or **DELETE**  button to change the value.
- 7) When set up is completed, hold the **POWER**  button for at least 2 seconds until the set up menu disappears. The setting will be saved.
- 8) Setting Date & Time :
 - The American date format is MM/DD/YY and that of the European is DD/MM/YY. For example: to set December 25th 2009 in American date format, please select 12/25/09. In European date format, please select 25/12/09.
 - The time format is 24 hour. For example: to set 7:30pm, please select 19:30.
- 9) Setting Chimes:
 - Five different chimes are available for selection. Simply change the value next to the  symbol to listen to the selected sound.
01: Ding-Dong 1 02: Ding-Dong 2 03: Westminster
04: London Bridge 05: Frere Jacques

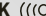
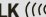
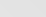
10) Setting Speaker Volume:

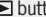
- The speaker / door bell volume of the indoor unit can be adjusted by the slide switch located on the right side of the unit. Three volume levels are available for selection: high, medium, low.

Operation

- 1) When the **DOOR BELL**  is pressed, the unit will produce a chime
- 2) Both the screen and intercom will turn on immediately. Real-time image of the visitor will appear on the screen.
- 3) Picture of the visitor will be taken automatically and stored in the memory.
- 4) Up to 140 pictures could be stored. When memory is full, the first picture taken will be deleted to make room for the latest one.
- 5) The unit will automatically switch to stand-by mode when left idle for 30 seconds. User can press either the **POWER**  or **PUSH TO TALK**  button to activate the device.
 - **When at home:**
- 6) User can communicate with the visitor by holding the **PUSH TO TALK**  button. Release the button to allow the visitor to reply.
- 7) Additional pictures of the visitors and their ID documents can be taken by pressing the **CAMERA**  button.
 - **When not at home:**
- 8) Pictures of each visitor will be taken automatically and stored in the memory.
- 9) To review pictures stored in the memory, turn on the unit by pressing the **POWER**  button, then press **PLAYBACK**  button to show the latest picture taken. A date and time mark will appear at the bottom of each picture. Press **PLAYBACK**  button again to scroll to the next picture at descending time order.
- 10) To erase a picture, use **PLAYBACK**  button to select and press **DELETE**  button. To erase all pictures, hold the **DELETE**  button for 2 seconds.

Remarks:

- o Picture will be taken automatically in about 3 seconds after the door bell is first pressed.

Warning

- Do not attempt to disassemble or alter any part of the equipment that is not expressly described in this manual. Internal inspections, alterations and repairs should be conducted by qualified service personnel authorized by the equipment supplier.
- Do not allow the unit to come into contact with, or become immersed in, water or other liquids. Do not allow liquids to enter the interior. The unit has not been waterproofed. If the exterior comes into contact with liquids or salt air, wipe it dry with a soft, absorbent cloth.
- Do not use substances containing alcohol, benzene, thinners or other flammable substances to clean or maintain the units. The use of these substances may lead to fire.
- Do not cut, damage, alter the cable wires. Any of these actions may cause an electrical short circuit, which may lead to fire or electrical shock.
- Do not place the batteries near a heat source or expose them to direct flame or heat. Neither should you immerse them in water. Such exposure may damage the batteries and lead to the leakage of corrosive liquids, fire, electrical shock, explosion or serious injury.
- Do not attempt to disassemble, alter or apply heat to the batteries. It could lead to an explosion and cause serious injury.
- In case of a battery leakage, immediately flush the affected area of the body with water, including the eyes and mouth, skin, or clothing that comes into contact with the inner contents of a battery. If the eyes or mouth contact these substances, immediately flush with water and seek medical assistance.
- Do not short-circuit the battery terminals with metallic objects, such as key holders. It could lead to overheating, burns and other injuries.

Proper Battery Handling

- Use only recommended batteries. Use of batteries not expressly recommended for this unit may cause explosions or leaks, resulting in fire, injury and damage to the surroundings.
- Use AA-size alkaline batteries only.
- Since the performance of alkaline batteries may differ according to brand, the operating time of the batteries you purchase may not be as long as the batteries that came with the DoorGuard.
- The operating time may be shortened at low temperatures.
- Never mix unused and partially used batteries. Always load four fresh batteries at the same time. The partially used batteries may leak.
- Never mix batteries of different types or from different manufacturers. All four batteries should be identical.
- Never use damaged batteries or batteries whose outer seal is completely or partially missing or peeled off, as there is risk that such batteries may leak, overheat, or burst. Always check the seals on store-bought batteries before loading them, as some batteries may come with defective seals. Do not use batteries with defective seals.
- Before inserting the batteries, wipe the battery terminals well with a dry cloth. Oil from one's skin or other dirt may cause a considerable reduction in the operating time.
- If you do not plan to use the unit for a long time, remove the batteries from the unit and store them in a safe place. Batteries may leak and damage the unit if left installed during prolonged periods of non-use.

Trouble Shooting

Problem	Remedy
The unit does not turn on	<ul style="list-style-type: none">Make sure you have installed the four batteries with the correct positive and negative directions.
The display shows a white screen	<ul style="list-style-type: none">Make sure the cable is plugged firmly into the socket of the indoor unit
After replacing batteries, the unit does not function properly	<ul style="list-style-type: none">Turn the unit OFF and wait for about 5 seconds and then turn it ON again to reset the unit.
There is a loud feedback noise when pressing the push to talk button	<ul style="list-style-type: none">Adjust the speaker volume to a lower level.
The unit switched off when I got to the door	<ul style="list-style-type: none">Press either the PUSH TO TALK (TALK) button or POWER (OFF) button to activate the screen.

Limited Warranty

Limited warranty and servicing is provided by your local distributor. Please contact your local distributor for limited warranty terms and conditions. To Contact your local distributor, please visit www.DoorOGuard.com for the up-to-date distributor list.

Product Registration

It is highly recommended that each of the DoorGuard purchased is registered at the following website www.DoorOGuard.com to receive latest product updates.

Contact Us

Protecta Technology Ltd:

Suite 1608, Tower 1, China Hong Kong City, 33 Canton Road, TST, Hong Kong

T: +852 2377 4996

E: info@protecta-technology.com

W: www.Protecta-Technology.com